



FERROVIAL AGROMAN
LAING O'ROURKE JV

Northern Line Extension

Kennington Green

Community Liaison Group

8 April 2019

Delivering the Northern line extension with

ferrovial
agroman



MAYOR OF LONDON



TRANSPORT
FOR LONDON



Kennington Green Jan – Apr 2019



- Track Completed – Kennington Green to Nine Elms Station
- Tunnel fit out works have progressed – cables, lights and pipework installation.

- Kennington Station – fit out works continue inside the hoardings until mid 2019



Kennington Green Jan – Apr 2019



Construction of the headhouse structure



Construction of the
basement structure

Kennington Green April – July 2019

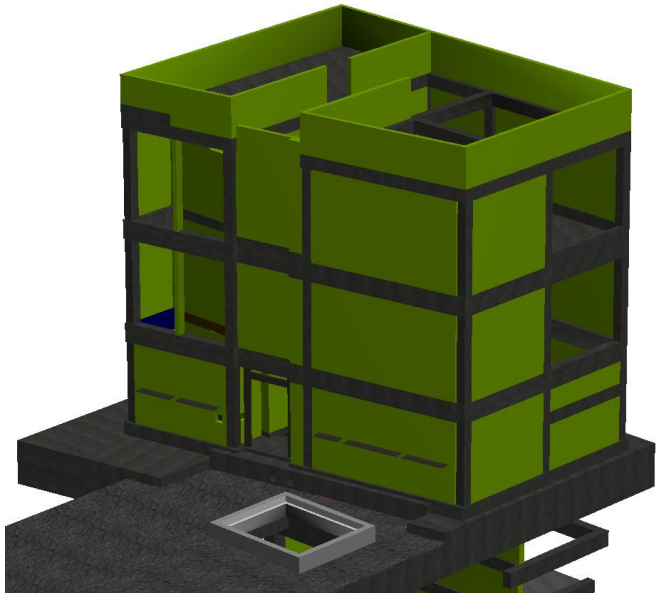

Headhouse construction will continue, works inside the basement will continue

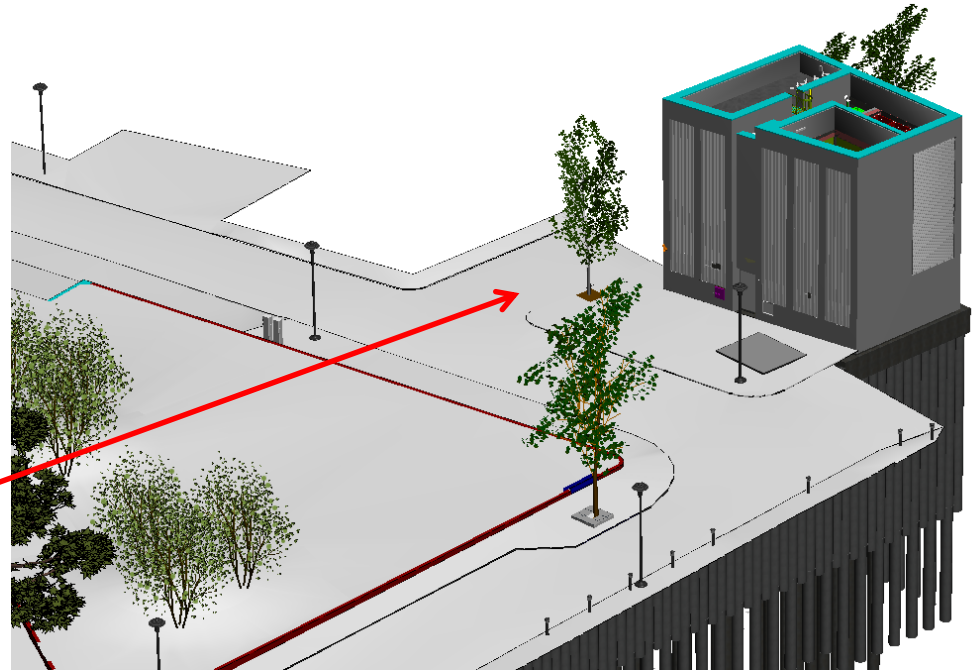

Utility connections at Montford Place / Kennington Road corner – rearrange to suit UKPN and Thames Water

Headhouse brickwork to start
May 19

Kennington Green April – July 2019



Headhouse construction will continue



Brick selection: Smeed Dean
Islington Rustica – Buff
London Stock

Kennington Green Works Timeline



FERROVIAL AGROMAN
LAING O'ROURKE JV

Activity	Start Date	End Date
Construction of basement – roof, walls, staircases	May 2018	May 2019
Kennington Green Headhouse - Superstructure - Ground to Roof Level <i>End date extended due to change of scope</i>	December 2018	May 2019
Kennington Green Brickwork to headhouse	May 2019	July 2019
Utility works scheduled to take place at the corner of Montford Place with Kennington Road <i>(rearranged to suit UKPN and Thames Water)</i>	June 2019	July 2019
Mechanical & Electrical Installation	February 2019	Spring 2020
Hard and Soft Landscaping Kennington Green – removal of remaining foundations and concrete surface from site, removal of hoardings etc	Spring - Summer 2020	



Kennington sites logistics



FERROVIAL AGROMAN
LAING O'ROURKE JV

- We continue to Work Related Road Risk (WRRR) driver training awareness for vulnerable road users, IE cyclists.
- 100% WRRR compliance is being maintained.
- Once abnormal deliveries have been authorised by the metropolitan police we alert the residents under section 61 explaining the reasons for either working early/late. In addition, there are no planned abnormal loads at present.
- Montford Place continues to be the holding area for deliveries
 - April – June '19 will be mainly trailers with blockwork and steel work, collections of falsework equipment.
 - Mobile cranes will attend occasionally to assist with lifting
- Approx. 10-15 lorries per day.



Enquiries and complaints

Stats for Kennington Green and Montford Place
between 7 January and 8 April 2019

Case status:

Total: 11 cases

Active : 3 (27%)

Resolved: 8 (73%)

Case type::

Total: 11 complaints

Enquiries: 7 (64%)

Complaints: 3 (27%)

Non valid: 1 (9%)

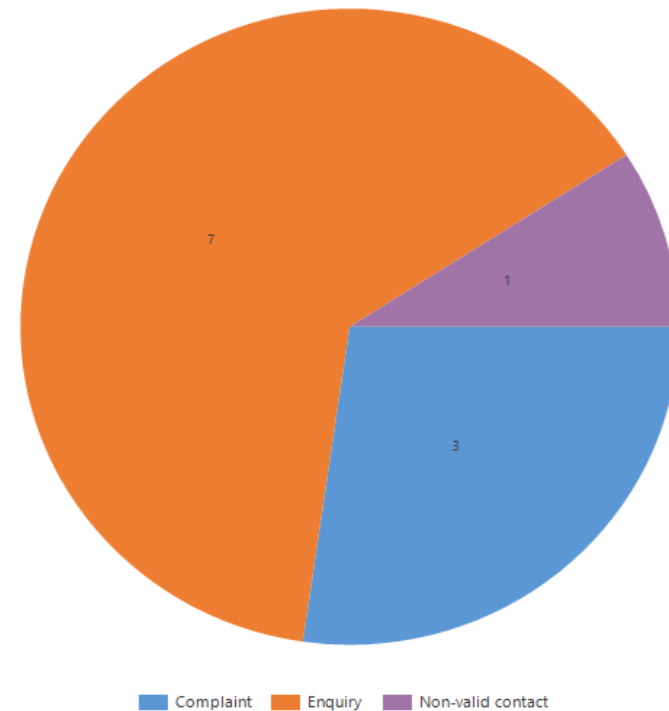
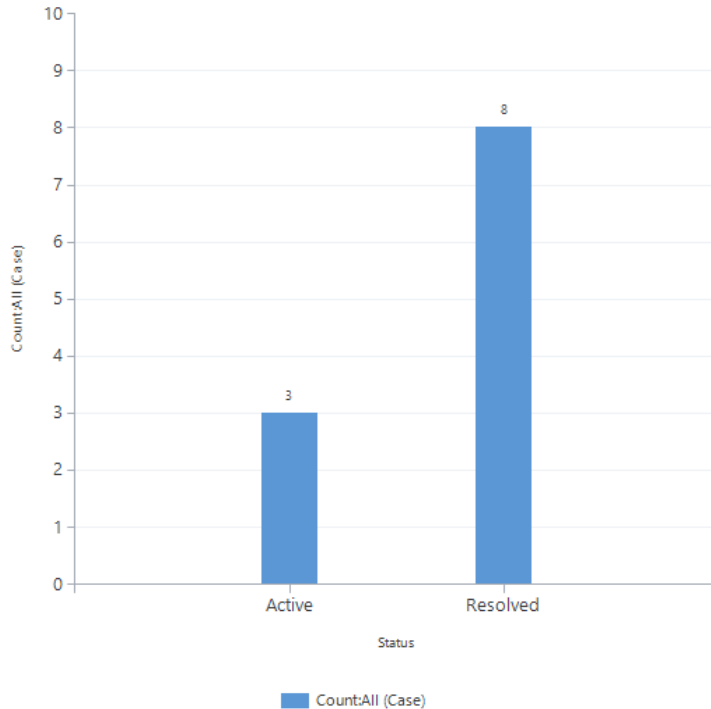

Community Engagement and NLE Skills and Employment



FERROVIAL AGROMAN
LAING O'ROURKE JV



TfL Careers fair



Careers event at Sacred Heart School

- TfL careers fair – March – City Hall Westminster
- ‘Construct’ employment fair with ‘Work Match’ – South Thames College, Wandsworth – Jan
- Construction Youth Trust events - Building H, Drummond Road, SE16 4EE – March. Meet the professionals – speed interviews



Harris Westminster 6th form college visit and panel Q&A session about route into construction



Kennington Green Monitoring points



FERROVIAL AGROMAN
JAIN O'ROURKE JV

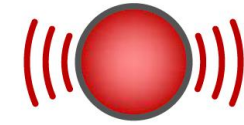
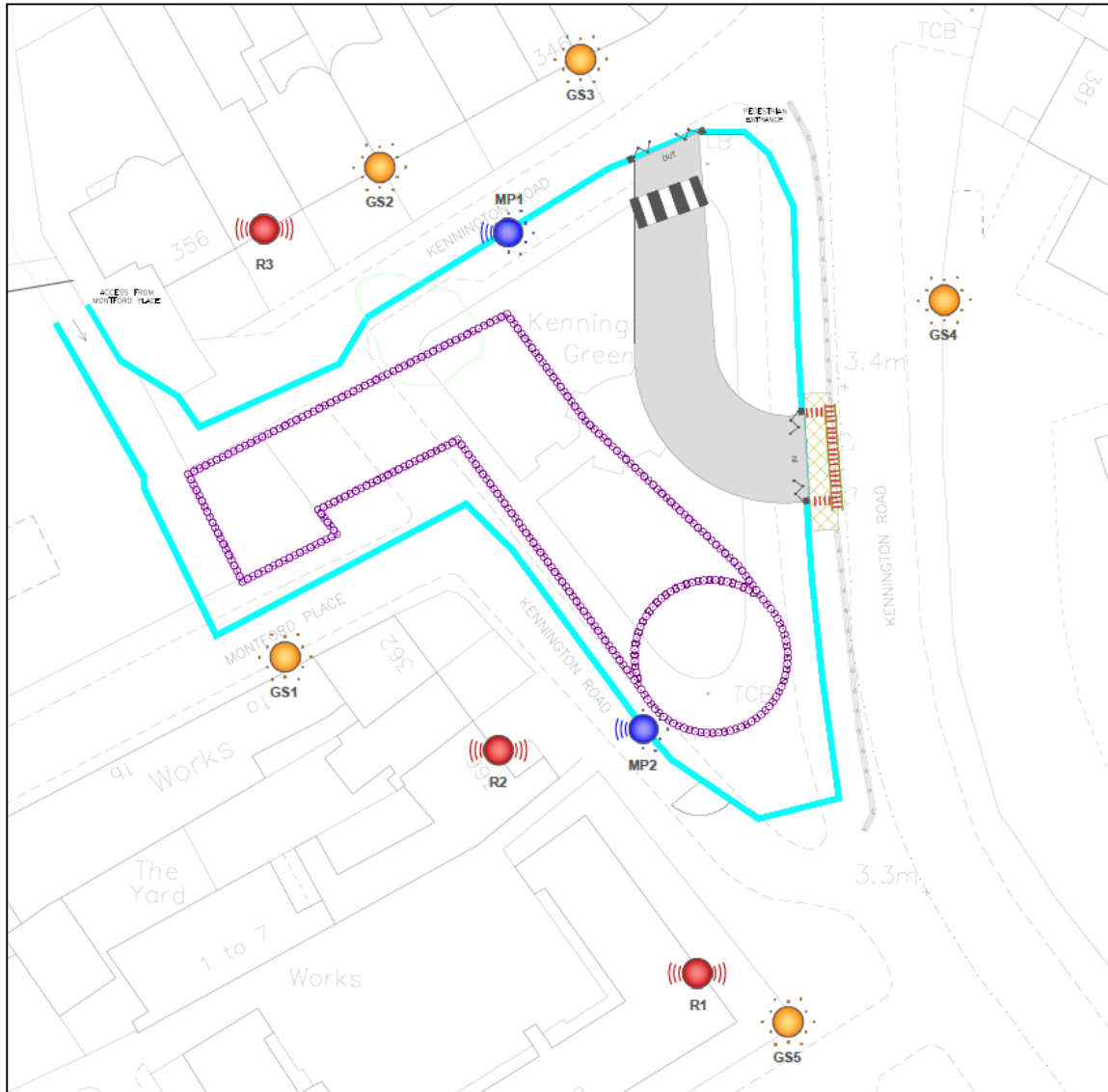

RECEPTOR

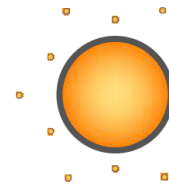

UNATTENDED DUST
MONITORING POSITION
(GLASS SIDE)

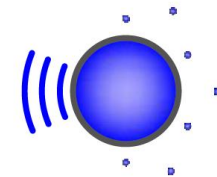

UNATTENDED
MONITORING POSITION



Measured noise levels at MP2 (south/ west)

Daytime Average

Noise Time History: Receptor R1 - Sherwin House

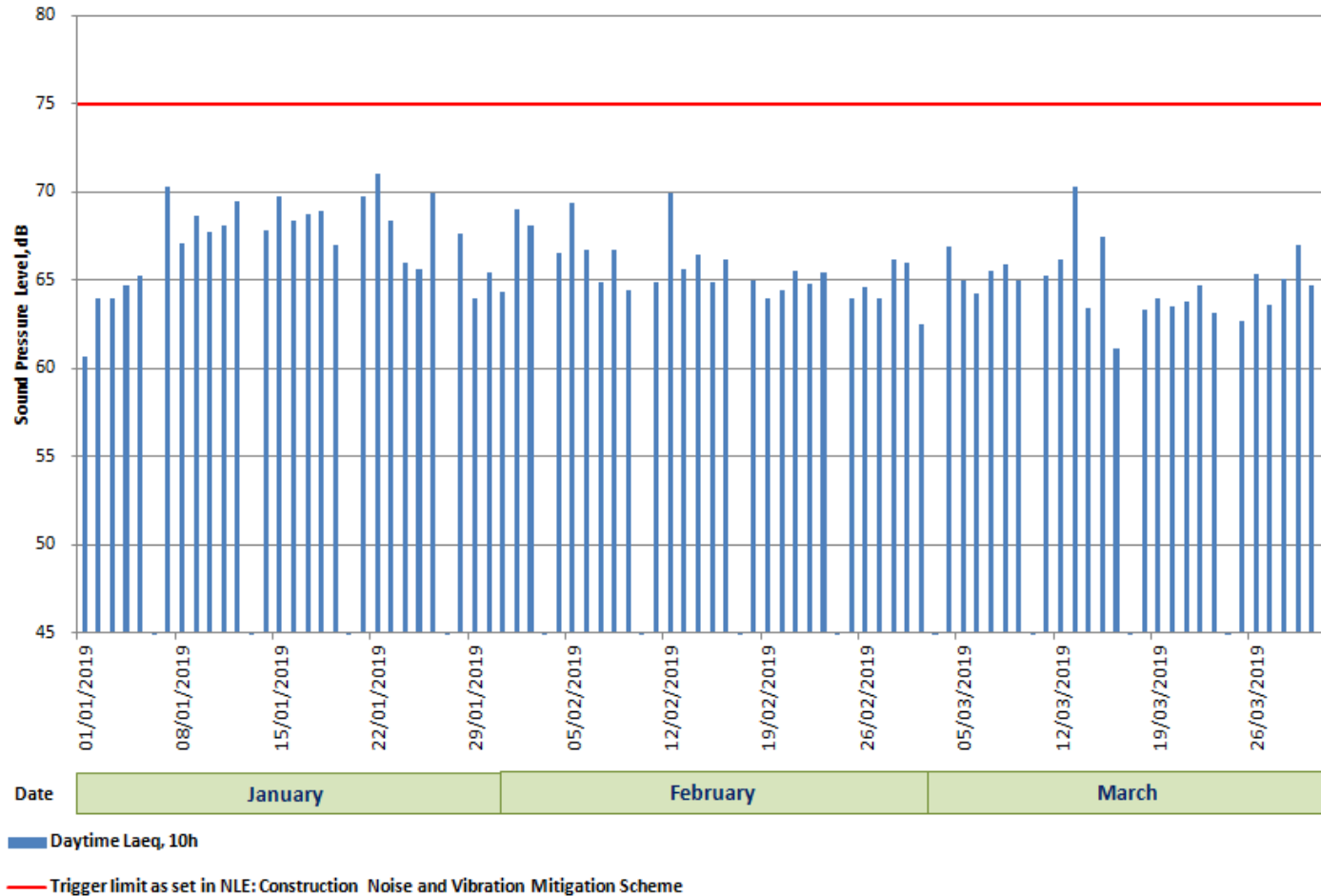

Measured noise levels at MP1 (North)

Daytime Average



FERROVIAL AGROMAN
LAING O'ROURKE JV

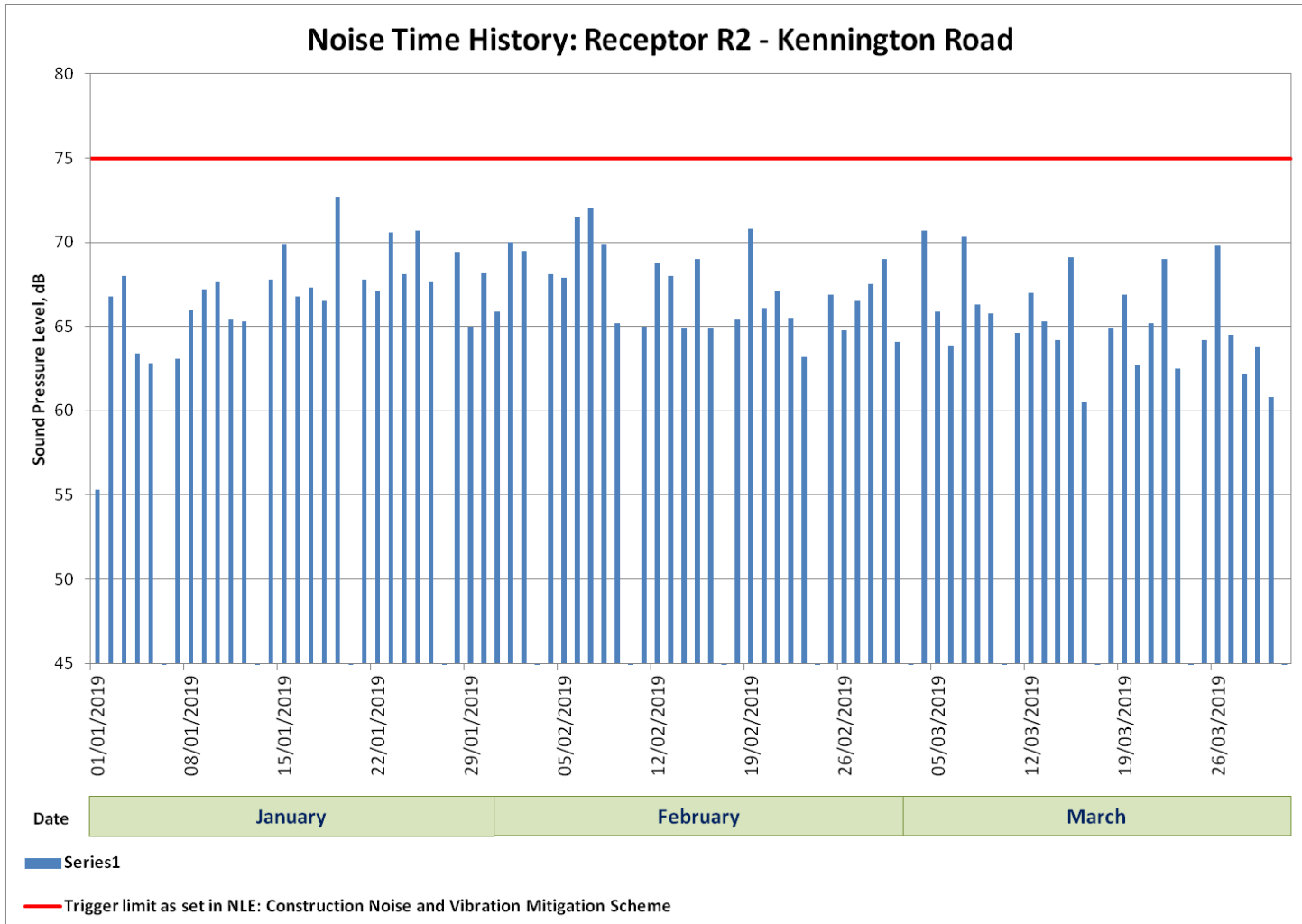

Monitoring – Glass Slide



NLE - Ken Green - Fortnightly Passive AQ monitoring

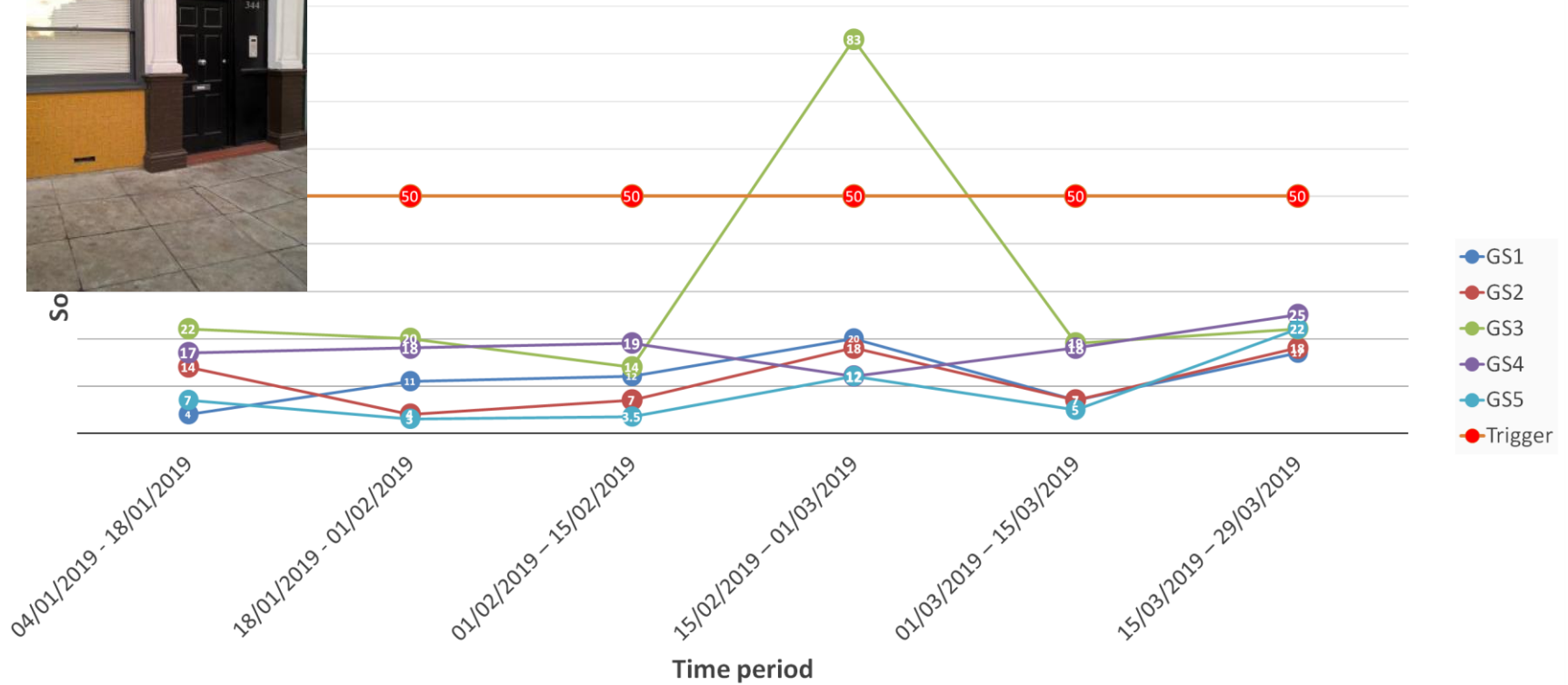

Ways to contact us

- It is important that calls are logged through the NLE 24/7 helpdesk on 0343 222 2424 (Option 1)
- Email nle@tfl.gov.uk
- Please visit:

<https://tfl.gov.uk/northern-line-extension>