



GT46/37/113

**ROAD TRAFFIC REGULATION ACT 1984 - SECTIONS 64 AND 65
AUTHORISATION OF TRAFFIC SIGNS AND SPECIAL DIRECTIONS**

The Secretary of State for Transport, in exercise of her powers under Sections 64 and 65 of the Road Traffic Regulation Act 1984, and of all other powers enabling her in that behalf, for the purpose of assisting in the free flow of vehicular traffic at the junctions of: Great Cambridge Road, Pasteur Gardens and Wilbury Way, Enfield; Finborough Road, Old Brompton Road and Warwick Road, Kensington and Chelsea; Commercial Road, Branch Road and Flamborough Street, Tower Hamlets; and East Cross Route (A12 Approach Road) and Wick Road, Hackney, for which Transport for London is the traffic authority, hereby:-

1. authorises the placing at or within the vicinity of the sites shown on the attached schedule of plans numbered GT46/37/113(Pt3)-5 of a traffic sign consisting of a road marking (hereinafter referred to as "the authorised marking") conforming as to size, colour and character with that shown in diagram 1043 in Schedule 6 to the Traffic Signs Regulations 2002 (Part I of SI 2002/3113, "the 2002 Regulations"), save that the overall shape of the authorised marking shall be as shown on the said schedule of plans; and
2. directs, without prejudice to any statutory provision to the like effect, that it is a condition of this authorisation that the placing of the authorised markings at or near the said sites shall continue to have effect only until such day as may be appointed by one month's notice given by the Secretary of State in writing to the traffic authority for the removal or alteration of the authorised marking and on that day the said authorisation shall, without prejudice to the giving of any further authorisation or direction, cease to have effect.



GT46/37/113

Section 36 of the Road Traffic Act 1988 shall apply to the authorised markings as it applies to the marking shown in diagram 1043 in Schedule 6 to the 2002 Regulations.

The provisions of Regulations 12 and 31 of the 2002 Regulations shall apply to the authorised markings in the same manner as they apply to the marking shown in the said diagram 1043.

Dated.....1 August.....2007

Signed by authority of the Secretary of State

.....
[Redacted Signature]

A Grade 7 Official of the Department for Transport

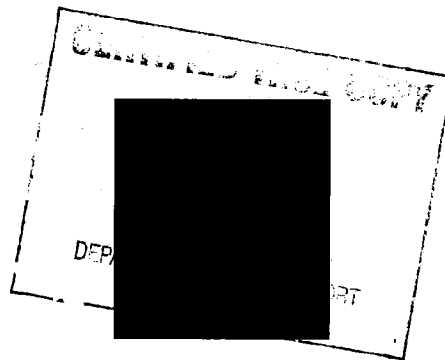

EXISTING ROAD MARKING

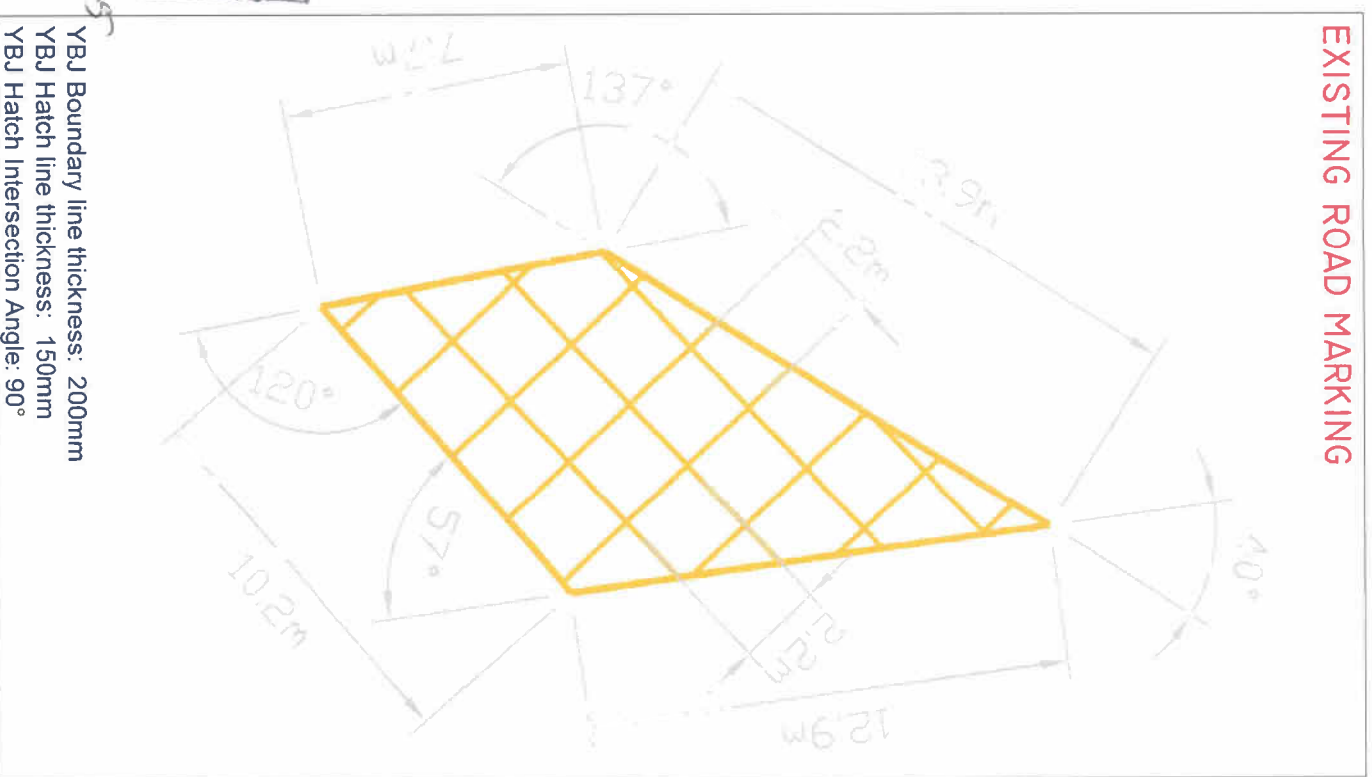
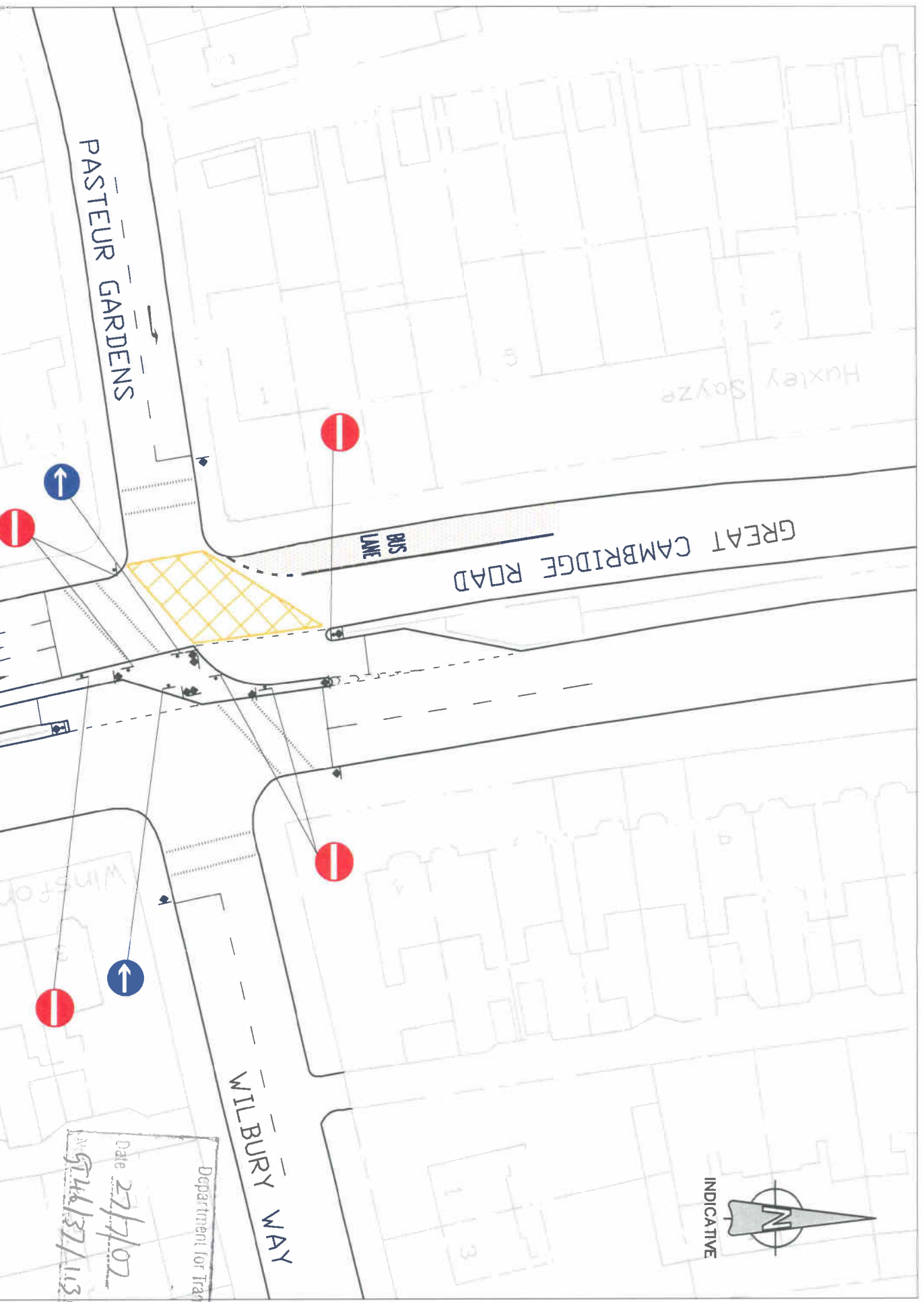

YBU Boundary line thickness: 200mm
 YBU Hatch line thickness: 150mm
 YBU Hatch Intersection Angle: 90°

Scale : 1/200

Date 27/7/07
 G146/37/113 (E3) 15

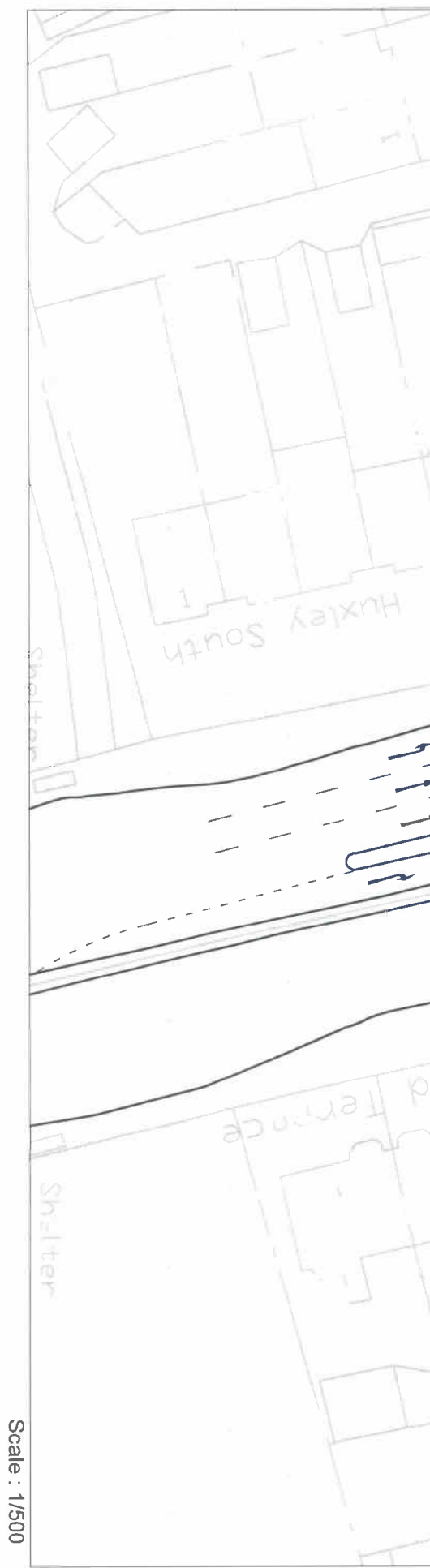

Scale : 1/500

Transport For London				
scale	date	DRN	CHK	APP
AS_SHOWN	13/04/07	GM	VG	AD



Transport For London
 Engineering Services

GREAT_CAMBRIDGE_ROAD/
 PASTEUR_GARDENS_-_WILBURY_WAY

NO ENFD_724_01

This map is reproduced from Ordnance Survey material with the permission of Ordnance Survey on behalf of the Controller of Her Majesty's Stationery Office © Crown copyright. Unauthorised reproduction infringes Crown copyright and may lead to prosecution or civil proceedings. (GAX100032373) (2002)

CAD