



GT46/37/113

**ROAD TRAFFIC REGULATION ACT 1984 – SECTIONS 64 AND 65  
AUTHORISATION OF TRAFFIC SIGNS AND SPECIAL DIRECTIONS**

The Secretary of State for Transport, in exercise of his powers under Sections 64 and 65 of the Road Traffic Regulation Act 1984, and of all other powers enabling him in that behalf, for the purpose of assisting the free flow of vehicular traffic at various junctions on roads for which Transport for London is the traffic authority, hereby:-

1. authorises the placing at the junctions shown in the attached schedule of plans numbered GT46/37/113(Pt2)-1 of traffic signs consisting of road markings (hereinafter referred to as “the authorised markings”) conforming as to size, colour and character with those shown in diagrams 1043 and 1044 in Schedule 6 to the Traffic Signs Regulations 2002 (Part I of SI 2002/3113, “the 2002 Regulations”), save that the overall shapes of the authorised markings shall be as shown on each plan on the said schedule of plans; and
2. directs, without prejudice to any statutory provision to the like effect, that it is a condition of this authorisation that the placing of the authorised markings at or near the said sites shall continue to have effect only until such day as may be appointed by one month's notice given by the Secretary of State in writing to the traffic authority for the removal or alteration of the authorised markings and on that day the said authorisation shall, without prejudice to the giving of any further authorisation or direction, cease to have effect.

Section 36 of the Road Traffic Act 1988 shall apply to the authorised markings as it applies to the marking shown in diagram 1043 in Schedule 6 to the 2002 Regulations.



GT46/37/113

The provisions of Regulations 12 and 31 of the 2002 Regulations shall apply to the authorised markings in the same manner as they apply to the marking shown in the said diagram 1043.

Dated 4 October .....2006

Signed by authority of the Secretary of State



.....  
A Grade 7 Official of the Department for Transport

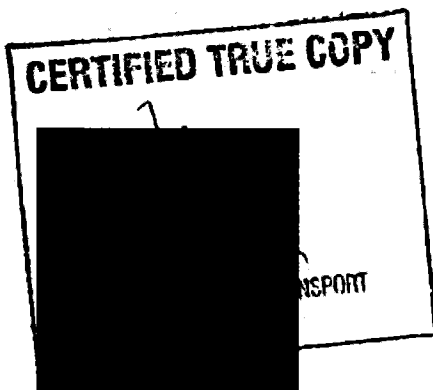

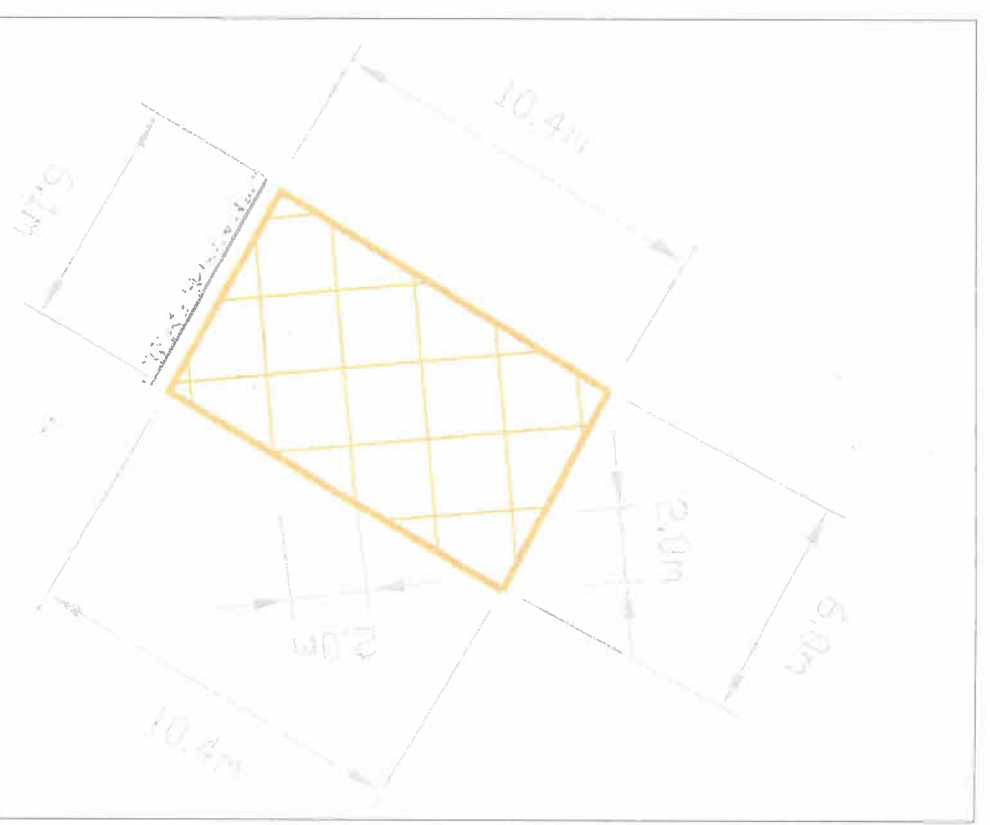
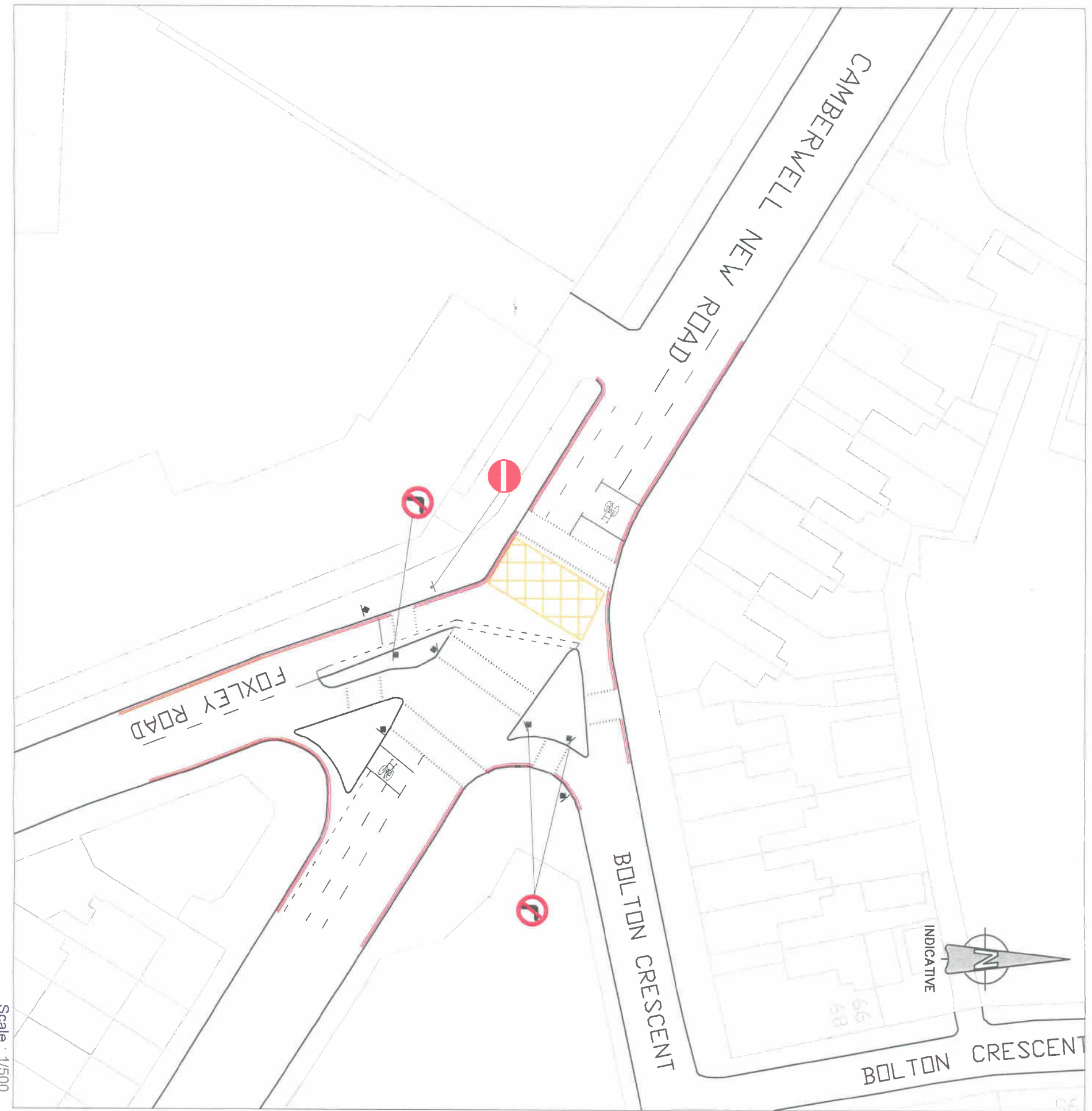

Department for Transport  
 Date: 28 Sept 2006  
 No: 514632/113(R12)-1  
 YBU Boundary line thickness: 200mm  
 YBU Hatch line thickness: 150mm  
 Scale: 1/200

Transport For London					
scale	date	DRN	CHK	APP	
AS_SHOWN	03/06/06	HF	BM	AD	



Traffic Enforcement  
 Engineering Services

FOXLEY\_RD\_/\_BOLTON\_CRESC\_/\_  
 CAMBERWELL\_NEW\_RD

No  
 LAMB\_455\_01  
 CAD

This map is reproduced from Ordnance Survey material with the permission of Ordnance Survey on behalf of the Controller of Her Majesty's Stationery Office. © Crown copyright. Unauthorised reproduction infringes Crown copyright and may lead to prosecution or civil proceedings. (SAX)10032379 (2002).