

Northern line extension

MONTHLY UPDATE

January–February 2016

Battersea Station

Dear neighbour

Continuing with the Northern line extension (NLE) works near you, we are now moving into new phases and would like to bring you up-to-date on what has been achieved pre - Christmas and advise you of the main activities planned for the coming 4-8 weeks.

What has been completed:

The pedestrian crossing and suspended bus stops have now been reinstated in Battersea Park Road and we have successfully completed the new signalised junction works. We expect the new junction to be operational by the end of January. As a result we will be closing the current entrance as illustrated in the diagram below.

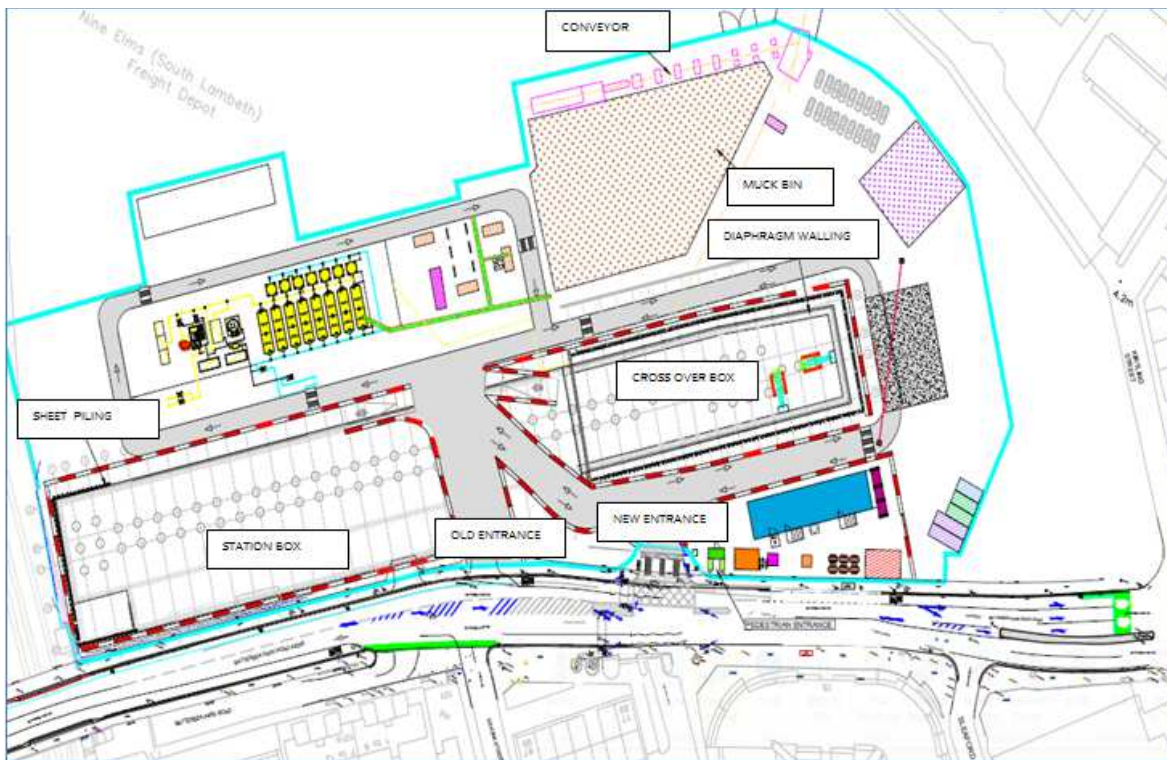

With the muck-away conveyor system fully operational, we were able to exceed our target by transporting 13,000 tonnes of material away by barge during November and December. We intend to continue our pledge to remove lorries from the road by transferring, on average, two 1000 tonne barges of material a week to our disposal site in Essex, equivalent to 100 lorries loads.

nle@tfl.gov.uk
 0343 222 2424

FLO-N205-2360000-COM-NTF-00007

tfl.gov.uk/northern-line-extension

PLEASE TURN OVER



The muck-away conveyor system in operation by the



An example of a concrete pour taking place

What is planned:

We are continuing to work on the construction of the diaphragm wall to form the primary structure of the Cross-Over Box. In conjunction with these works, it is necessary to carry out very large concrete pours to construct the walls. We will always endeavour to complete these works within our core working hours, however on occasions due to the size of the concrete pour on some panels, this may overrun. This is not a particularly noisy activity, however due to lorry movements and machinery being operational, we will communicate this information to you with as much notice as possible and local authorities will also be informed. We expect this phase of works to conclude in March.

Extended working hours are now: **Monday to Friday from 07:00 to 19:00 and on Saturdays 08:00 to 14:00**
 Extended concrete pours may occur between **19:00 and 22:00 Monday to Friday**.

This has been granted by the Local Authority to increase the efficiency of the diaphragm walling and muck-away operations. There will also be a requirement, on at least 12 occasions, to carry out further very large concrete pours during **24 hour operations** as stated above.

In early February we expect to start sheet piling on the West side of site (as shown on the map). We will be using a vibration free technique whereby each pile will be pushed into the ground. A press rig and a service crane will be delivered to site to carry out these works. We estimate this activity to last around 3 weeks. Please note that due to the size of the sheet piles, this delivery will need to be carried out outside of core working hours in accordance with the highways authorities and as instructed by the Metropolitan Police. We will advise the community when this is taking place.

Your feedback is important to us. Please do get in touch if you have any questions about the works or would like to attend the next Community Liaison Group meeting taking place on 18 January 19:00-20.30 at the Rose Community Centre, Ascalon Street

If you have any concerns or queries, please contact us at nle@tfl.gov.uk or call our 24/7 helpdesk on 0343 222 2424 (Option 1)

nle@tfl.gov.uk
 0343 222 2424