

Northern Line Extension

BI-MONTHLY UPDATE

September-October 2017

Battersea Power Station

Thank you for your patience whilst we continue with the Northern Line Extension (NLE) works near you. We would like to update you on where we are and what is planned over the next couple of months.

What has been completed:

During July and August, construction of basement level -1 was completed, with the final concrete pour carried out at the beginning of August. Excavation works at basement level -2 continued with the aim of completion for mid-September. A clam shell grabber was brought onto site during August to assist with the construction of basement level -4; this will eventually become the platform level of the final station. Please see image below of the station construction and its levels.

Surface works to support the tunnelling continued and will do so until the end of tunnelling at the end of 2017. The Tunnel Boring Machines have reached Nine Elms and are making their way towards Kennington approximately 1257 metres have so far been completed in the northbound tunnel and 1601 metres in the southbound tunnel as of Sunday 27 August 2017.

Barge movements happen at any time of day or night and are planned to coincide with the tides. In some cases, the times of the tides have required barges to attend at early hours of the morning. As sound can travel across open water, we have installed monitoring equipment along the jetty in order to monitor the levels and ensure that we remain within agreed limits as set by the local authority.

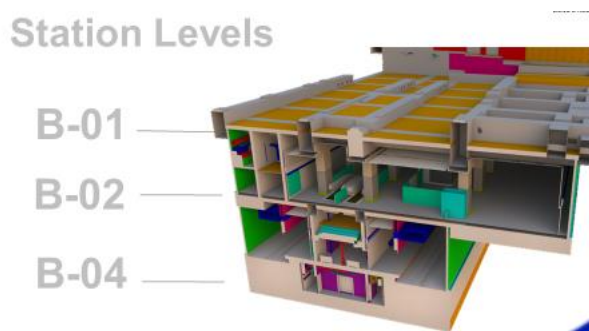

Above – an image of the station and its levels

What is planned:

Over the next two months, we will continue with construction of the station basement level -1 with the installation of propping beams, used to keep the perimeter walls of the box stable during the construction process.

Please see overleaf

During this time we will begin excavating down to basement level -4, which will eventually become the platform level of the station, the clam shell grabber will assist in lowering materials and equipment down to that level.

Work on the rest of the station box will continue as before, with excavations and installation of precast beams, as well as concrete pours.

As the evenings begin to draw in and darken early, site lighting will increase to allow for operatives to continue working on the construction of the station. We will work hard to ensure that the lighting is not disruptive to you.

Working hours for tunnelling and surface tunnel support are now **24 hours/7 days a week**. We do everything we can to minimise night time noisy works. This will include deliveries arriving to site between **07:00** and **20:00** Monday to Saturday and the barge movements **24/7** during the tunnelling period to remove excavated material.



Above – inside the Tunnel Boring Machine

Our core working hours for non-tunnelling activities are **Mondays to Fridays 08:00 to 18:00** and **Saturdays 08:00 to 13:00** with quiet maintenance allowed between 13:00 and 18:00.

If you have any concerns or queries, please contact us at nle@tfl.gov.uk

or call our 24/7 Helpline on **0343 222 2424 (Option 1)**