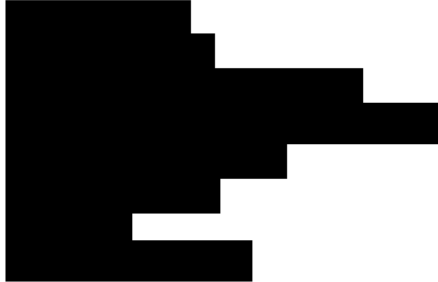

RiverLinx CJV

**For the Attention of:**Date: 6<sup>th</sup> October 2020

Our Reference: GRN-CJV-RGB-21

Dear 

**The Silvertown Tunnel Order 2018 ('the Order'), application for approval of an Archaeological Written Scheme of Investigation – made under Schedule 2 of the Order to partially discharge the requirement at Paragraph 5 - limiting the scope of the application.**

I am writing regarding the Archaeological Written Scheme of Investigation (AWSI) pertaining to the intended Riverlinx CJV works to be undertaken within the Royal Borough of Greenwich.

During the course of the determination period, GLAAS provided a number of comments related to later stages of our construction that we would like to address in the form of a separate application to be submitted in due course.

GLAAS has also confirmed that they are content for our most imminent works (the provision of a temporary Coach Park) to proceed as they will not have any archaeological impact.

I would therefore like to limit the scope of the application solely to the Coach Park works, and works within limits that do not involve any excavation. I attach a plan showing the limit of the Coach Park works area (red line).

If you have any queries relating to this reduction of scope please don't hesitate to contact me on [REDACTED].

Yours Sincerely,

[REDACTED]

[REDACTED]

Planning Consents Lead, Riverlinx CJV

[REDACTED]



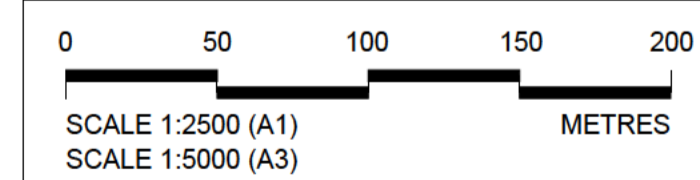
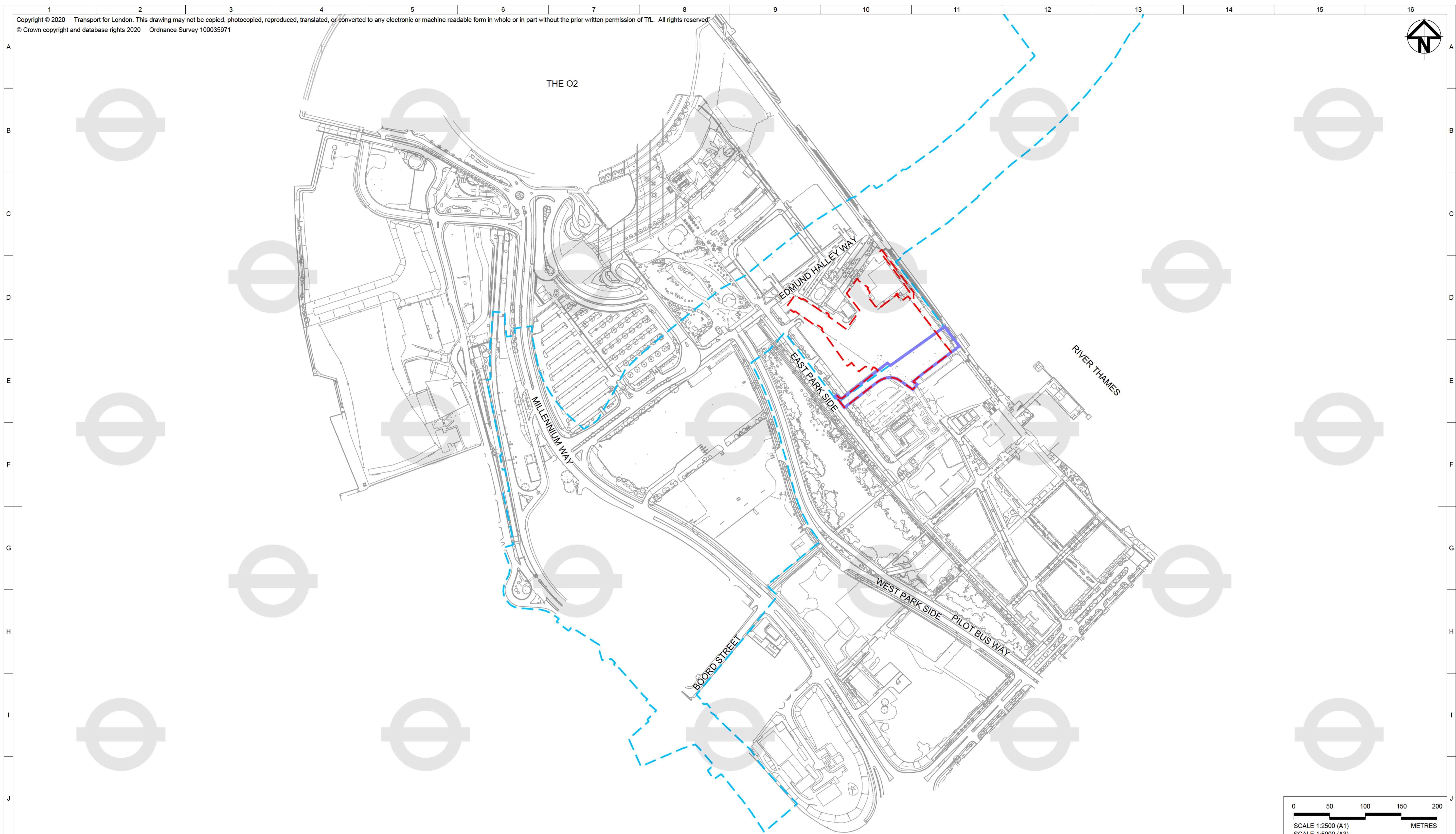
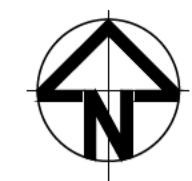

Key plan



**NOTES:**

- ALL DIMENSIONS ARE IN METRES UNLESS OTHERWISE STATED.

**LEGEND:**

- - - DEVELOPMENT CONSENT ORDER (DCO) BOUNDARY
- - - LIMIT OF COACH PARK WORKS
- AREA SUBJECT TO SEPARATE PLANNING APPLICATION

Restricted	Rev	Date	Drawn	T. Checked	T. Approved	P. Approved	Authorised
	P01	15/09/20	CP	OK	AM		
	Purpose / Description						
	S3 Fit for Internal Review and Comment						

Project	Silvertown Tunnel
Originator	Arcadis
Location	Greenwich
Asset Classification	Multiple Asset Classification
Lifecycle	Detailed Design
Suitability	S3

Title		Location Plan
Drawing Number		ST150030-ARC-MAC-06-ZY-SKE-HE-0001
Rev.	P01	